

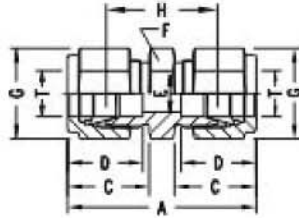

Union



METRIC OD Tubes

| T Tube OD | Fluid Fit Part No. | A | C | D | E min. | F A/F | G A/F | H |
|-----------|--------------------|------|------|------|--------|-------|-------|------|
| 3 | UM-3 | 35.3 | 15.3 | 12.9 | 2.4 | 11 | 11 | 22.1 |
| 6 | UM-6 | 41.0 | 17.7 | 15.3 | 4.8 | 14 | 14 | 26.2 |
| 8 | UM-8 | 43.2 | 18.6 | 16.2 | 6.3 | 16 | 16 | 28.2 |
| 10 | UM-10 | 46.2 | 19.5 | 17.2 | 7.9 | 17 | 19 | 31.0 |
| 12 | UM-12 | 51.2 | 22.0 | 22.8 | 9.5 | 22 | 22 | 31.0 |
| 14 | UM-14 | 52.0 | 22.0 | 24.4 | 11.1 | 24 | 25 | 31.0 |
| 15 | UM-15 | 52.0 | 22.0 | 24.4 | 11.9 | 24 | 25 | 31.8 |
| 16 | UM-16 | 52.0 | 22.0 | 24.4 | 12.7 | 24 | 25 | 31.8 |
| 18 | UM-18 | 53.5 | 22.0 | 24.4 | 15.1 | 27 | 30 | 33.3 |
| 20 | UM-20 | 55.0 | 22.0 | 26.0 | 15.9 | 30 | 32 | 34.8 |
| 22 | UM-22 | 55.0 | 22.0 | 26.0 | 18.3 | 30 | 32 | 34.8 |
| 25 | UM-25 | 65.0 | 26.5 | 31.3 | 21.8 | 35 | 38 | 40.4 |

Fluid Fit Engineers

Unit 11, Pereira Compound, Near Vaishali Nager, S. V. Road

Mumbai-400 102, Maharashtra (India)