

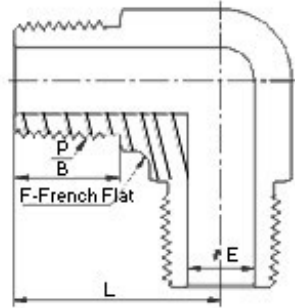

Elbow Male x Male (NPT)



Elbow Male x Male (NPT)

P-NPT Size (in.)	Basic Ordering Number	L	F	E Minimum Opening	B
1/16	ME-NS1	18.3	9.5	3.0	9.7
1/8	ME-NS2	19.3	11.1	4.8	9.7
1/4	ME-NS4	27.7	14.3	7.1	14.2
3/8	ME-NS6	31.0	19.1	9.7	14.2
1/2	ME-NS8	37.3	22.2	11.9	19.1
3/4	ME-NS12	40.4	27.0	15.7	19.1
1	ME-NS16	50.0	33.3	22.4	23.9

Fluid Fit Engineers

Unit 11, Pereira Compound, Near Vaishali Nager, S. V. Road

Mumbai-400 102, Maharashtra (India)