

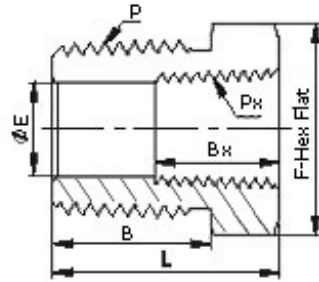

Reducing Bushing



Reducing Bushing

P-NPT Size (in.)	Px-NPT Number	Basic Ordering Number	L	F	B	Bx	E Minimum Opening
1/8	1/16	RB-NS2-NS1	26.2	11.1	9.7	9.9	4.8
1/4	1/16	RB-NS4-NS1	21.8	14.3	14.2	9.9	4.8
1/4	1/8	RB-NS4-NS2	26.9	14.3	14.2	10.4	7.7
3/8	1/16	RB-NS6-NS1	21.8	17.5	14.2	9.9	4.8
3/8	1/8	RB-NS6-NS2	21.8	17.5	14.2	10.4	8.6
3/8	1/4	RB-NS6-NS4	30.2	19.1	14.2	15.0	9.7
1/2	1/8	RB-NS8-NS2	27.4	22.2	19.1	10.4	8.6
1/2	1/4	RB-NS8-NS4	27.4	22.2	19.1	15.0	11.4
1/2	3/8	RB-NS8-NS6	35.8	22.2	19.1	15.0	11.9
3/4	1/8	RB-NS12-NS2	27.4	27.0	19.1	10.4	8.6
3/4	1/4	RB-NS12-NS4	27.4	27.0	19.1	15.0	11.4
3/4	3/8	RB-NS12-NS6	27.4	27.0	19.1	15.0	15.0
3/4	1/2	RB-NS12-NS8	41.4	27.0	19.1	19.8	15.7
1	1/8	RB-NS16-NS2	34.8	34.9	23.9	10.4	8.6
1	1/4	RB-NS16-NS4	34.8	34.9	23.9	15.0	11.4
1	3/8	RB-NS16-NS6	34.8	34.9	23.9	15.0	15.0
1	1/2	RB-NS16-NS8	34.8	34.9	23.9	19.8	18.5
1	3/4	RB-NS16-NS12	47.0	34.9	23.9	20.6	22.4

Fluid Fit Engineers

Unit 11, Pereira Compound, Near Vaishali Nager, S. V. Road

Mumbai-400 102, Maharashtra (India)